

INSTALLATION INSTRUCTIONS

DESCRIPTION: Windscreen Kit

PART NUMBER: B5H-F83J0-V0

MODEL: '19~ YXZ1000R



⚠ WARNING

Please read and understand these instructions completely before installation to avoid possible injury, or damage to the accessory or vehicle.

- Both sides of windshield can get dirty quickly in dusty or muddy conditions. When operating in such conditions, carry fresh water and towels to clean the windshield if vision becomes impaired. Driving with impaired vision can result in an accident.

WARRANTY INFORMATION:

In the United States, see your authorized Yamaha dealer for a copy of the Yamaha Genuine Parts and Accessories Limited Warranty.

DEALER OR INSTALLER:

These instructions contain important information for future reference and *must* be given to the customer.

NOTICE:

This installation is complex. It should be performed by an authorized Yamaha dealer or qualified technician.

PARTS LIST:

No.	Part Number	Description	Qty
--	B5H-F83J0-V0	Windscreen Kit	--
①	-	Windscreen	1
②	B5H-F83L0-V0	Rear Roof Rest w/Grommet	2
③	2HC-F1719-V0	Grommet	2
④	B5H-F114B-V0	Hinge Bracket	2
⑤	B5H-F1158-V0	Roof Bracket	2
⑥	2HC-F384J-V0	Ball Stud	4
⑦	2HC-F6294-V0	5/16 inch Nylock Nut	2
⑧	B5H-F11C5-V0	M6x35mm Button Head Bolt	2
⑨	2HC-F11C5-V0	M6x65mm Button Head Bolt	4
⑩	B5H-F5326-V0	8mmx75mm Pin	2
⑪	B5H-F5677-V0	R Clip	2
⑫	90201-06023	18mm OD Washer	10
⑬	90111-06803	M6x25mm Button Head Bolt	2
⑭	90179-06054	M6 Nyloc Nut	6
⑮	-	Position Support Arm (Center vented position support arm)	2
⑯	2HC-F7417-V0	Rubber Washer	8
⑰	2HC-F1459-V0	Spacer	4
⑱	2HC-F512-V0	25mm OD Washer	4
⑲	2HC-F3119-V0	M6x16mm Torx Bolt	4
⑳	B5H-F72C2-V0	Clamp (A-Pillar pivot clamp)	2
㉑	91347-06020	Hex Socket Bolt M6x20mm	2
㉒	91347-06040	Hex Socket Bolt M6x40mm	2
㉓	90201-06042	12 mm OD Washer	2
㉔	B5H-F7115-V0	Link	2
㉕	B5H-F1459-V0	30mm Spacer	2
㉖	B5H-F3147-V0	19mm O-Ring	2
㉗	B5H-F3188-V0	8mm O-Ring	4
㉘	2HC-F15A2-V0	Rubber Strap	2
㉙	B5H-F1719-V0	Grommet	2
㉚	B5H-F6298-V0	Spacer Plate	4
㉛	B5H-F281A-V0	Weather Seal	4ft.
㉜	B5H-K7529-T0	Rubber Pad	2
㉝	B5H-F8344-V0	Adhesive Pad	2
㉞	B5H-F11C5-T0	M6x30mm Button Head Bolt	2
㉟	B5H-F11C5-S0	M6x20mm Button Head Bolt	2
㊱	958380-10700	M10 Jam Nut (For mounting accessory mirrors if installed)	2

* Part supplied with kit only and not available separately

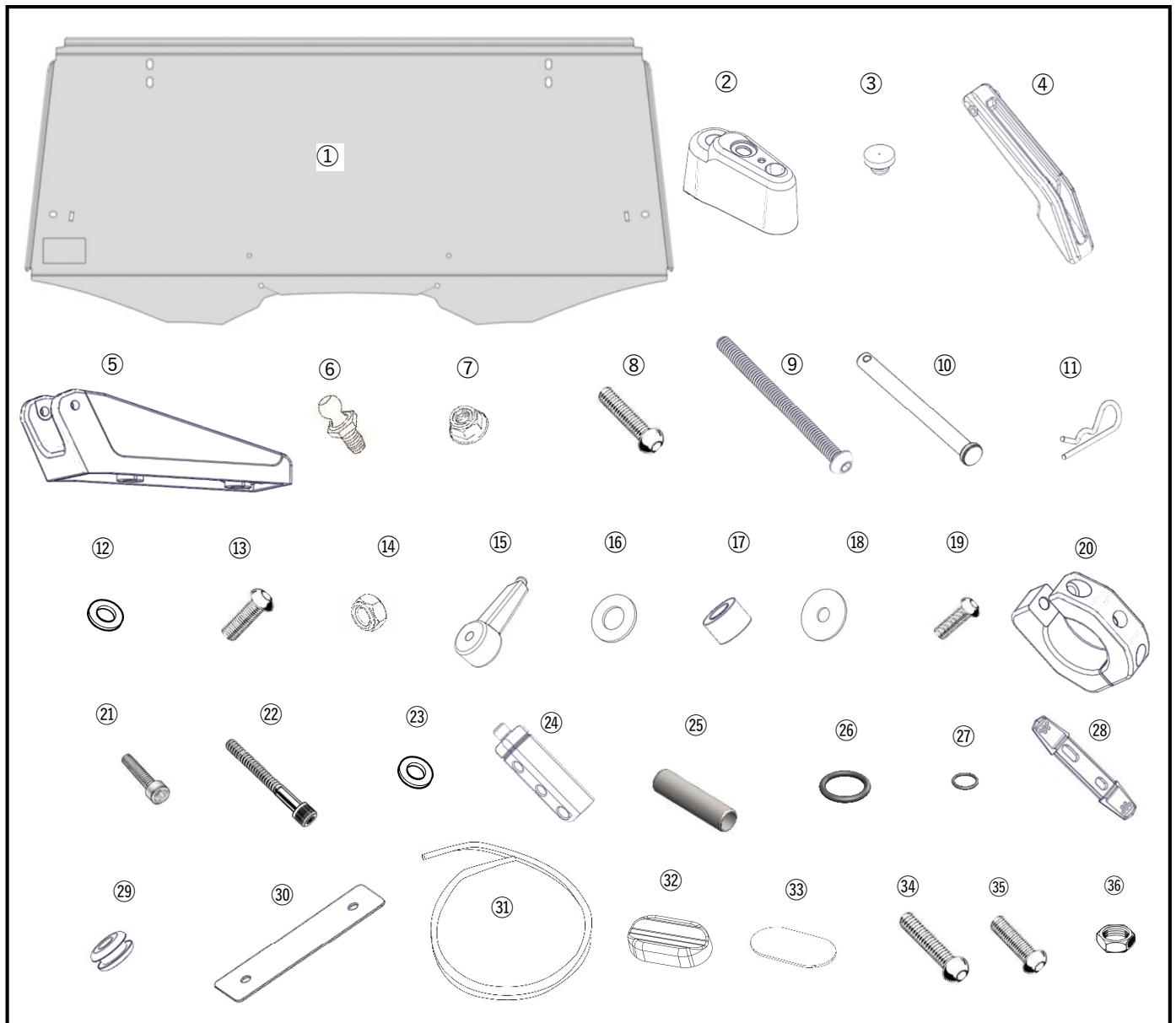

Windscreen on Vehicle

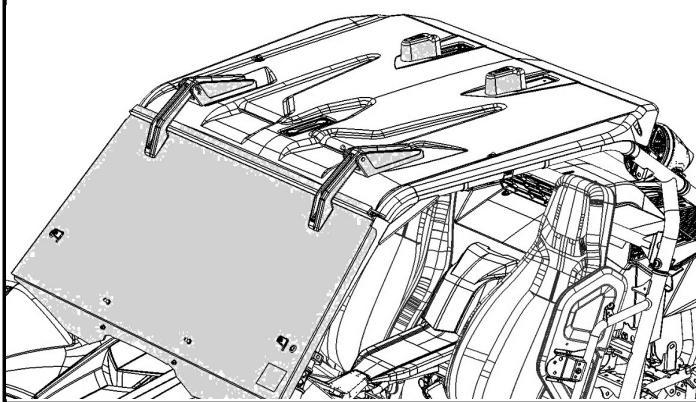

PREPARATION:

- Place the vehicle on a secure and level surface.
- Set the parking brake.
- **Clean the mount surfaces before starting installation.**

Tools Needed for This Installation

You will need these tools and materials:

- Torque Wrench
- Drill
- 5/16" drill bit
- 10mm Socket
- 10mm Wrench
- 13mm Socket
- 13mm Hex wrench
- 4mm Hex wrench
- Torx Bit set
- 5mm Hex wrench

Fig. 1

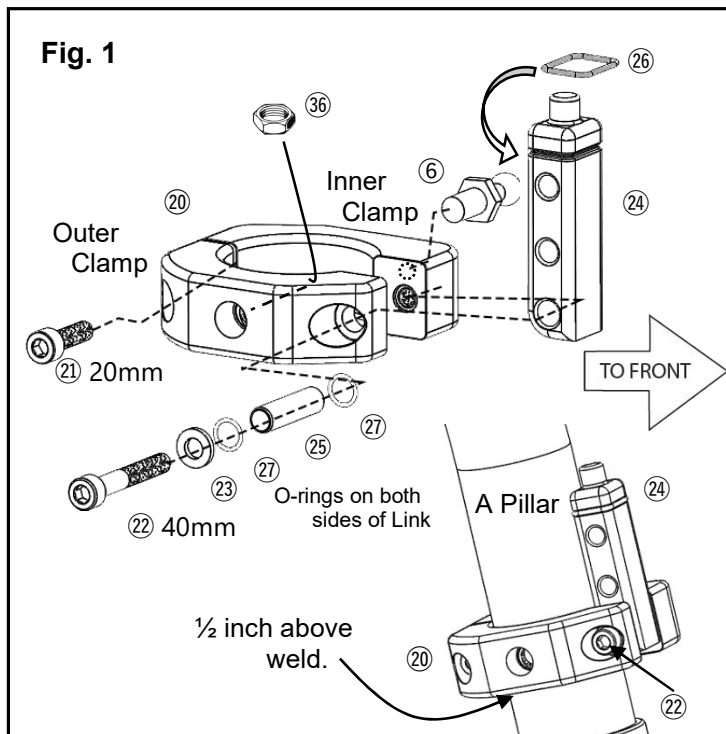

INSTALLATION: Assemble Retainer Arms

1. Assemble Retainer Arms (2) on the vehicle. Working at the front of the vehicle on the A-Pillar ROPS tube, thread a ⑥ Ball Stud into ②⑩ Inside Clamp.
2. Insert one ③⑥ M10 Jam Nut into the hex shaped pocket on the inside of the Clamp. Hold the Outer Clamp in place against the ROPS tube (about ½ inch above the weld at the A-pillar).
3. Install ②③ Washer onto ②② M6x40mm bolt, Install the bolt through ②⑩ Outer Clamp. Slide ②⑤ 30mm Spacer onto the ②② M6x40mm Bolt and install one ②⑦ O-ring onto the end of the ②⑤ 30mm Spacer, slide ②② M6x40mm Bolt with Spacer through the last hole in the ②④ Link.
4. Install the other ②⑦ O-ring to the end of the ②⑤ 30mm Spacer and thread the ②② M6x40mm Bolt into the ②⑩ Inner Clamp. Install the ②① M6x20mm bolt and thread into the ②⑩ Inner Clamp. Leave loose to allow movement along ROPS tube. Install the ②⑥ 1.5mm O-Ring into the channel on the Link. (Fig. 1)
5. Torque ⑥ Ball Stud to 6Nm (0.6 kg-m or 4.4 lb-ft). Tighten the ②② M6x40mm Bolt to 6Nm (0.6 kg-m or 4.4 lb-ft). tube end. Tighten rear ②① M6x20mm bolt 6Nm (0.6 kg-m or 4.4 lb-ft) last.

Fig. 2

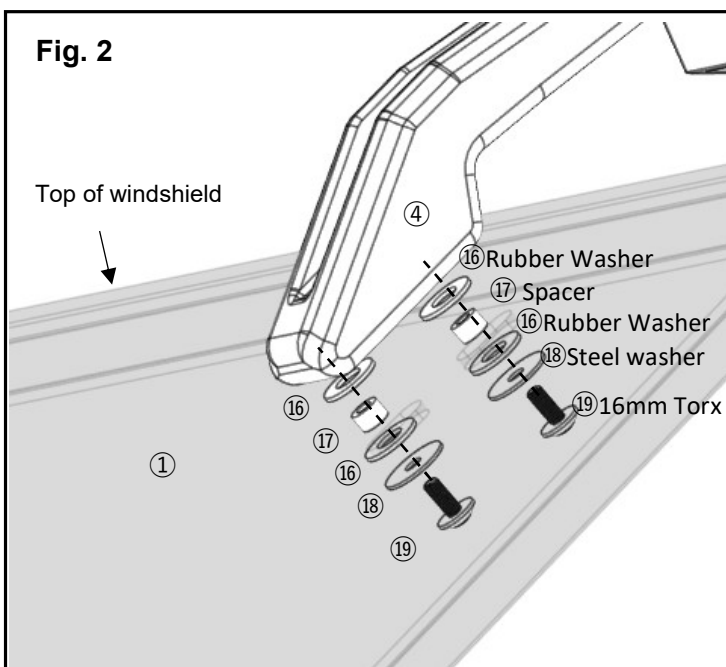

Install Hinge Brackets to Windshield

6. From the inside of the ① Windscreen, insert the ①⑨ M6x16mm bolt through the top hole on the left side of the ① Windscreen.
7. Place a ①⑧ Large Washer onto the ①⑨ M6x16mm bolt, followed by a ①⑥ Rubber Washer. (inside the windshield)
8. Place a ①⑦ Spacer, followed by a second ①⑥ Rubber Washer over the end of the ①⑨ M6x16mm Bolt and thread into the hole in the ④ Hinge Bracket closest to the hinge end. (Fig. 2)
9. Repeat steps 3 through 5 for the bottom hole.
10. Repeat the process in steps 3 through 6 to install the other ④ Hinge Bracket to the right side of the ① Windscreen and leave loose.

Fig. 3

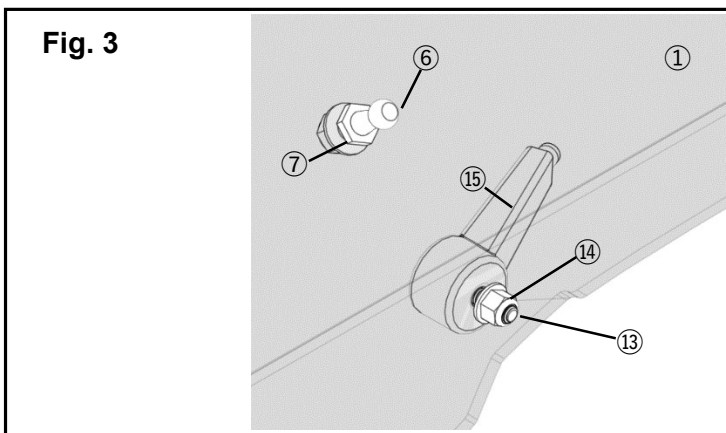

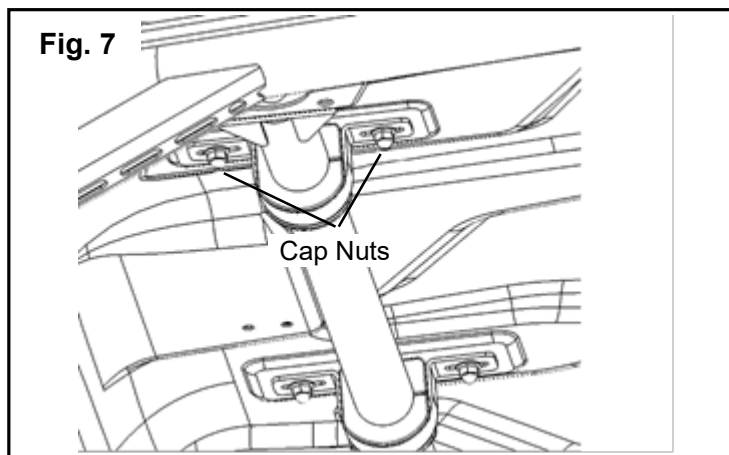
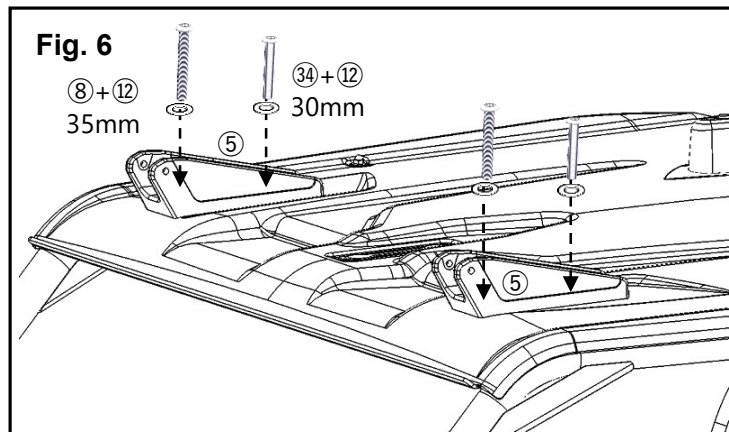
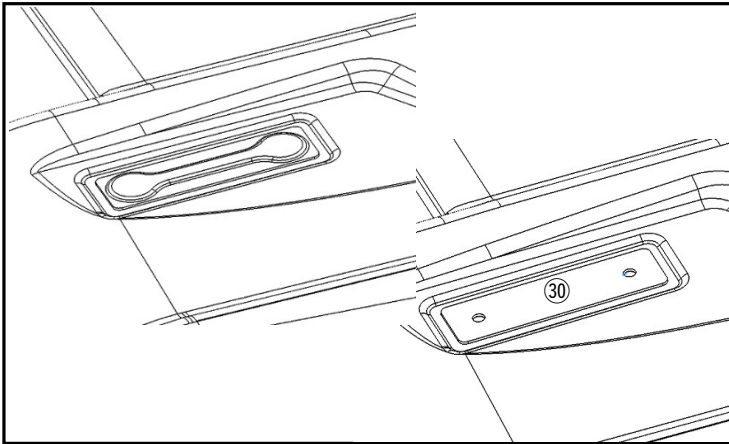
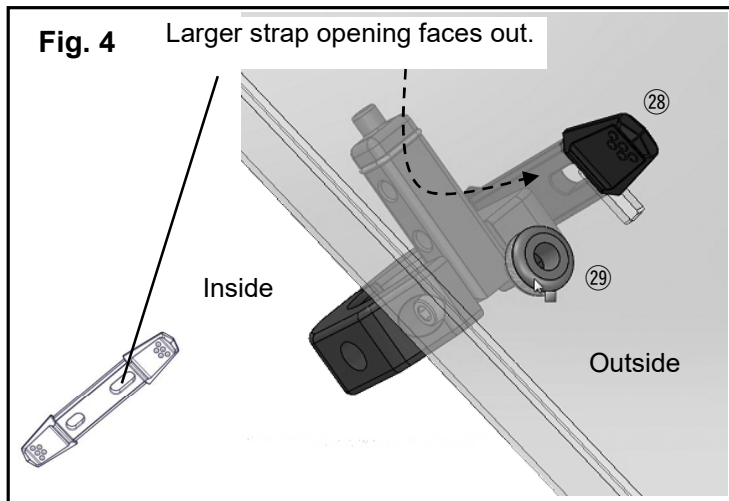

11. Install two ⑥ Ball Studs into pre-drilled holes in the ① Windscreen and install a ⑦ 5/16" Nylock Nut to each ⑥ Ball Stud. Torque to 6Nm (0.6 kg-m or 4.4 lb-ft). (Fig. 3)
12. Fit the ⑮ Position Support Arm to the ① Windscreen and align the mount hole in the arm with the hole in the ① Windscreen. Install one ⑬ M6x25mm through the mount holes and thread one ⑭ M6 Nyloc nut onto the bolt. Snug nut and bolt until arm does not rotate freely. Install Rubber Straps to Windscreen.
13. With the ① Windscreen closed against the cowl, install ⑳ Rubber Straps as shown in (Fig. 4) Insert the end of the strap that has the larger opening through the hole in the windscreen.
Tip: Use soapy water to help lubricate the strap to pass it through the hole in the windscreen. It is a tight fit. The other end of the ㉘ Rubber Strap is pressed onto the ⑥ Ball Stud. (Fig. 3)
14. Install two ㉙ Rubber Grommets into the round holes on the ① Windscreen next to ㉘ Rubber straps. (Fig. 4)

Install Front Roof Brackets

15. Working from inside the vehicle cab, remove four capped nuts on the two outside forward mounts. Retain for reuse. The two clamps are reused and can be left in place.
16. On the Sun Top, remove two stock stud plates from the roof, and replace with two ㉚ Spacer Plates one on each side. Fig. 5 shows stud plates removed and spacer plates installed.
17. Working from outside, install two ⑤ Roof Brackets. Install ⑤ Roof Brackets using two bolts, two washers, and two cap nuts per bracket. Install the ⑧ M6x35mm bolts into the front holes, and the ㉛ M6x30mm bolts into the rear holes. (Fig.6)
18. Pass the bolts through the ⑤ Roof Brackets, the re-installed stock roof clamps, and thread the cap nuts on to the bolts. Leave loose for adjustment. (Fig. 7)

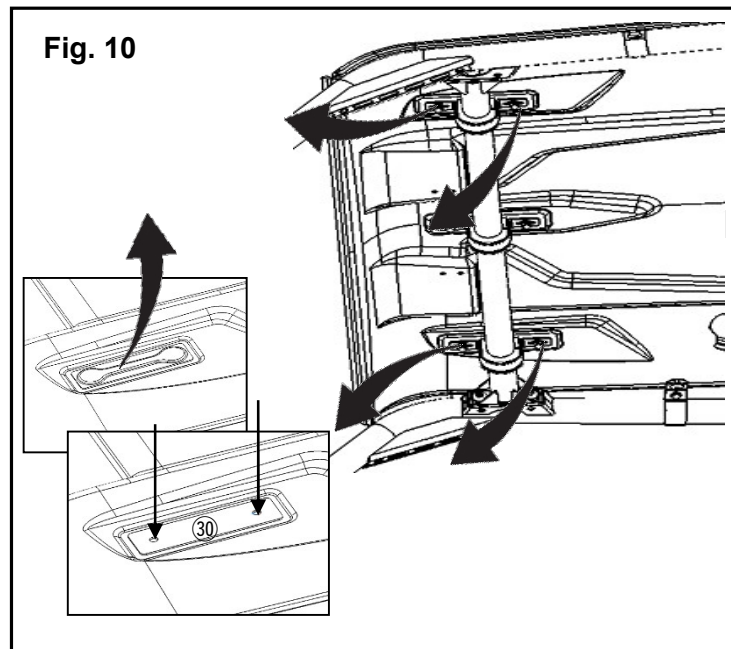
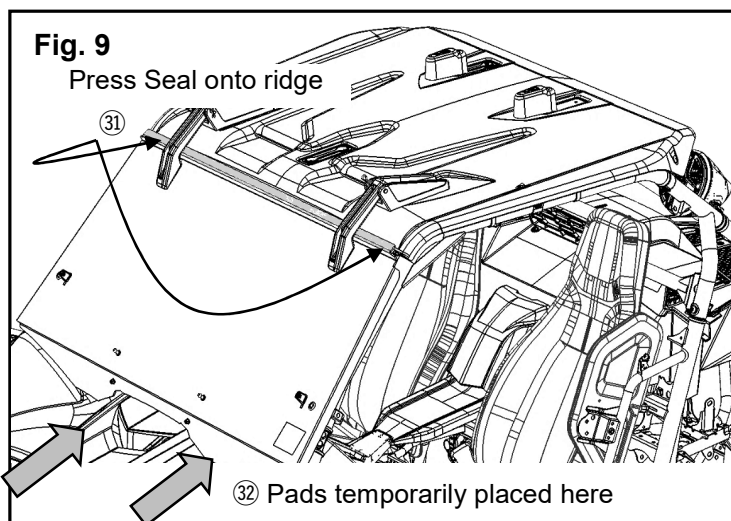
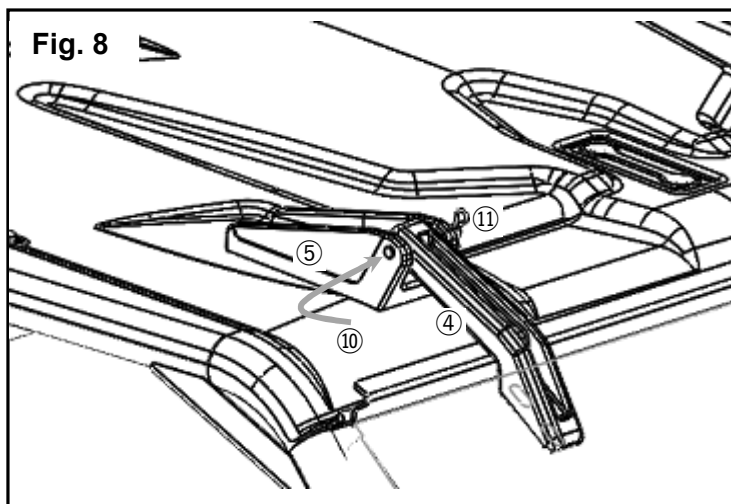

Install Windshield to Front Roof Mounts

19. Align the holes in the ④ Hinge Brackets with the holes in the ⑤ Roof Bracket. Insert ⑩ M8x75mm Pin through the outside hole in each ⑤ Roof Bracket and through the ④ Hinge Bracket. Install one ⑪ R-clip in each end of the ⑩ M8 Pins. (Fig. 8)

Install Seal

20. Rotate the ① Windscreen back and test fit ③① Weather Seal to the roof and determine how much to cut from one end. Press the seal onto the entire front edge of the Sun top. Cut to length with a set of tin snips. (Fig. 9)
21. Rotate the ① Windscreen forward. Adjust both roof hinge mounts brackets front and back as well as the ① Windscreen up and down and side to side. Adjust the fitment until the seal rests in the corner of the top bend of the ① Windscreen when in the closed position.
22. Place the ③② Rubber Pads under the front edge of the ① Windscreen to check the fit to the hood. This step is critical for the fitment of the final installation. (Fig 9)

Warning: Ensure a correct fit before drilling the two holes in the hood and two in the Sun top (detailed in Steps 27-31).

23. With the Hinge and Roof brackets and seals installed, press the ① Windscreen into the closed position. Tighten the ⑮ Position Support Arm to the ① Windscreen and tighten the ⑤ Roof Bracket bolts to 3Nm (0.3 kg-m or 26 in-lb).

Install Rear Roof Rests

24. Working from inside cab, remove the stock left and right rear roof clamp capped nuts. Retain two for reuse. (Fig. 10)
25. Remove the two stock stud plates from the roof, and place two ③① Spacer Plates in their place. (Fig. 10)
26. Place the two ② Rear Roof Rests onto the ③① Spacer Plates. The rear hole of the ② Rear Roof Rests aligns to the front hole of the ③① Spacer Plate. (Fig.11)
27. From the inside, install one ⑨ M6x65mm Hex Socket Button Bolt and one ⑫ 18mm OD Washer into the rear mount of the ② Rear Roof Rests. Leave this loose to allow adjustment. (Fig. 11)

Fig. 11

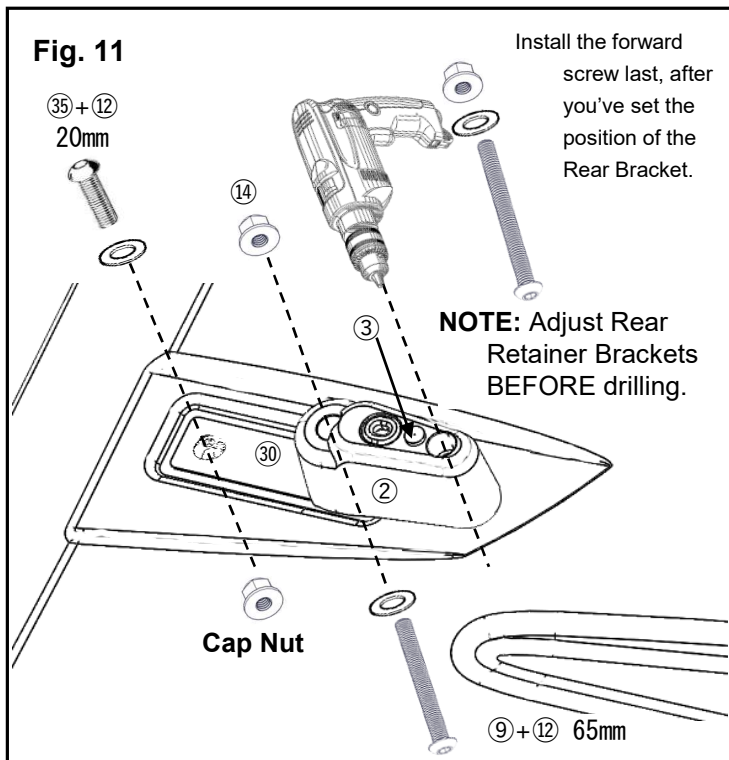
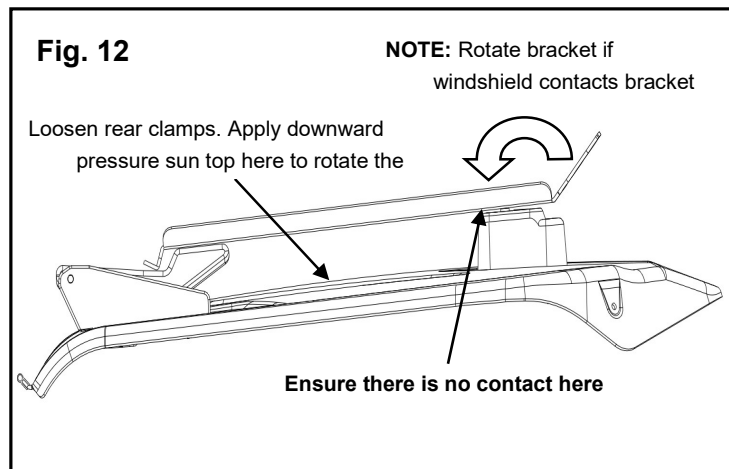

Fig. 12



Note: The pad adhesive will not cure unless the ambient temperature is above 70 degrees F for 24 hours. If the temperature cannot be achieved, then remove the hood and store in a climate controlled environment for the duration of the cure time.

If this procedure is not followed, the pads may not stay adhered to the hood.

- Do not close the ① Windscreen without installing the Rubber Pads. Damage will occur to the hood and painted surfaces.

Note: If not installed, press in the ③ Grommet into the open slot in each ② Rear Roof Rests.

28. Install one ⑫ 18mm OD Washer onto one ③⑤ M6x20mm Button Head bolt and pass bolt through the ③⑩ Spacer Plate from inside and thread on a stock cap nut to secure it. Leave loose to allow adjustment. (Fig.11)

Use Windscreen to Set Rear Mount Position

29. Rotate the ① Windscreen to the rear and insert the ⑥ Ball Studs from the windscreen into the grommets in the ② Rear Roof Rest.
30. Adjust the position of the ② Rear Roof Rests so that the ⑥ Ball Stud is firmly seated in the center of the oval slot in the grommet. If the screen contacts the bracket, or the ball studs do not align with the grommets, the bracket may need to be rotated forward for proper alignment.
31. Rotate the ① Windscreen forward. Loosen the two clamps on the ROPS tube (underneath the bracket) and press down on the Sun top from above to rotate the bracket.
32. Tighten the brackets before releasing pressure on the top. If no adjustments are needed, tighten the four nuts and bolts that secure the two brackets. (Fig. 11 and 12)
33. Rotate the ① Windscreen forward. Use the two ② Rear Roof Rests as drill guides to drill through the Sun Top - from the top.
- Note:** Use a 5/16-inch drill bit – at least (65mm) 2 ½ inches long.
34. Install the last two ⑨ M6x65 Button Head Bolts with ⑫ 18mm OD Washers through ② Rear Roof Rest and Suntop with ⑭ M6 Nuts and torque to 6Nm (0.6 kg-m or 4.4 lb-ft). (Fig. 11)

Install Pads and Drill Holes for Support Arms

35. Place the ③② Rubber Pads between the hood and the ① Windscreen and mark the exact locations of the ③② Rubber Pad on the Hood with a piece of tape.

Notice: Clean the hood locations and the bottom of ③② Rubber Pads with rubbing alcohol before installing the ③③ Adhesive Pads to the ③② Rubber Pads. Press the ③② Rubber Pads to the hood in the location you marked.

Fig. 13

Install ③③ Adhesive Pads and ③② Rubber Pads to Hood.

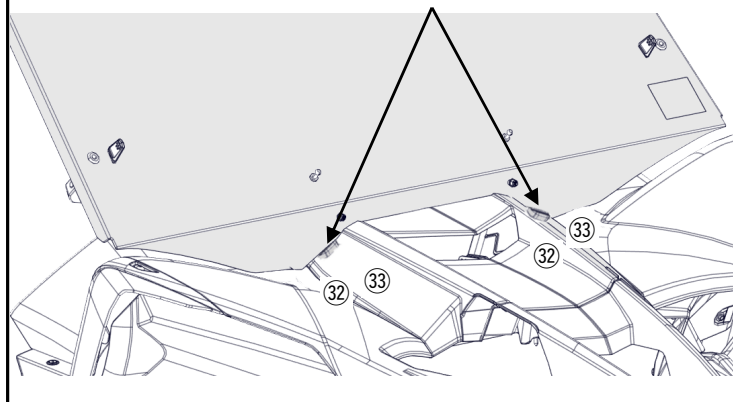
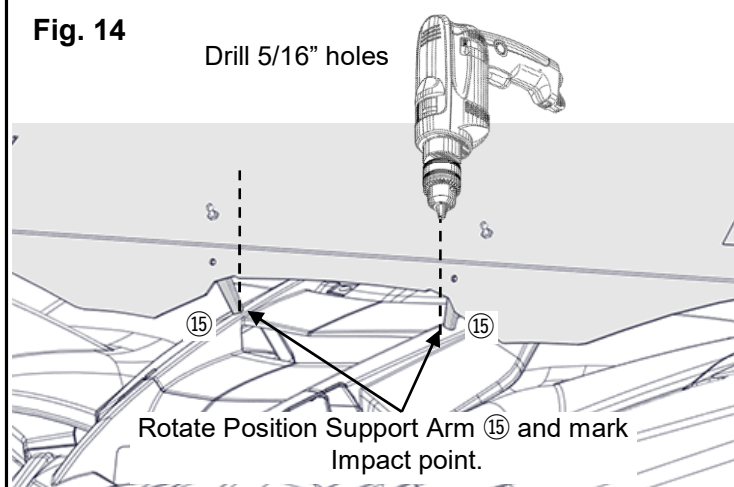

Fig. 14

Drill 5/16" holes



Note: The Suntop hardware can be loosened and the top moved slightly fore or aft if needed to improve fit of the windshield. Retighten if adjustments are made. (Fig. 13)

37. Adjust ⑮ Position Support Arms if needed and retighten. Rotate the ⑳ Link into ① Windscreen and attach the ㉘ Rubber Straps to ⑥ Ball Studs. Rotate ⑮ Position Support Arm towards the hood – and mark the impact point. (Fig. 14)
38. Use that point as a drill mark and drill a 5/16-inch hole in the hood – one hole for each ⑮ Position Support Arm. The nub on the arm fits through this hole. (Fig. 14)

MAINTENANCE:

Periodically, check torque and tightness on all hardware and. If loose hardware is found, re-torque or re-tighten.

CARE AND CLEANING:

Use Yamaha Windshield & Visor Plastic Cleaner & Conditioner (p/n ACC-PLASP-OL-11) to clean the windscreen.

CUSTOMER SERVICE:

For further information see your Yamaha dealer.

ESTIMATED TIME TO INSTALL: 2.0 HR